



# The Original All Steel Carriage House Series

Patent Pending

Now you can have the beauty and design of old style carriage house doors that are

**1/2** the price of wood

**1/2** the weight of wood

**1/2** the maintenance

**Twice** the warranty



A1-Adobe door with optional hardware and Small Stockton Arch door line

**Adobe**



C1-Cimarron door with optional hardware and Small Stockton Arch door line

**Cimarron**



E1-El Dorado door with optional hardware and Large Stockton Arch door line

**El Dorado**



P1-Pecos door with optional hardware and Colonial door line

**Pecos**



S1-Santa Fe door with optional hardware and Stockbridge Two Bar door line

**Santa Fe**



T1-Taos door with optional hardware and Small Plain View door line

**Taos**



R1-Ranchero door with optional hardware and Large Stockton Arch door line

**Ranchero**



WWW.FIRSTUDT.COM

"Sensational Sectionals"

Say goodbye to boring garage doors. Say hello to artistic, customized Original All Steel Carriage House Series garage doors from 1<sup>ST</sup> United Door Technologies.

1<sup>ST</sup> United Door Technologies

7255 S. Kyrene, Suite #104

Tempe, Arizona 85283

Phone: 480-705-6632 • Fax: 480-705-8497

sales@firstudt.com

Riverside California Distribution Center

1885 Iowa Avenue

Riverside, CA 92507

Phone: 951-787-8956 • Fax: 951-905-5211

calsales@firstudt.com

08360/FIR  
BuyLine 4566

## Upgrade Options

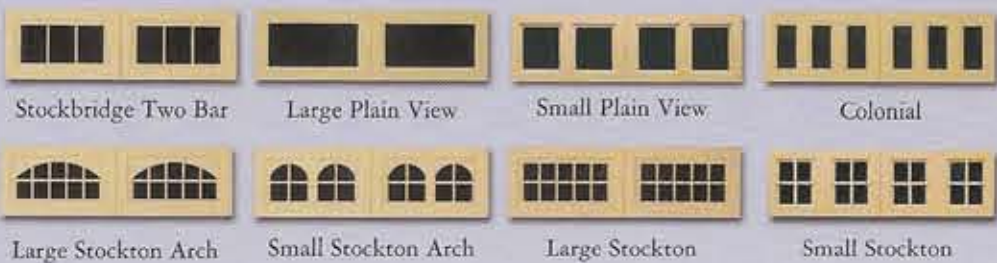

**DESIGNER GLASS OPTIONS:** Eight glass designs are available, and the glass types offered are: DSB clear, Tinted, Obscure, and Seedie.



**DECORATIVE HARDWARE OPTIONS:** (1) Standard Handle, (2) Arrowhead Handle, (3) Dome End Twist Handle, (4) Rosette Concave Handle, (5) Black Lock Twisted Lever with Escutcheon, (6) Drop Ring Pull Handle, (7) Drop Ring Twist Handle, (8) Half Round Door Bolt; and four styles of Hinge Straps in lengths of 8", 12", or 18" — (9) Decorative Economy Hinge, (10) Arrowhead Hinge, (11) Rosette Hinge, (12) Dome Hinge.

## Specifications

### Original All Steel Carriage House Series Specifications

Sections are 2-inch thick in 24-inch and 28-inch heights and are manufactured from heavy-duty 23 gauge hot-dipped galvanized steel. Sections are prime painted white and rotary embossed with a woodgrain texture. Tongue and groove meeting rails are roll formed into the panel incorporating the RITS reinforced integral truss system. CFC-free polystyrene insulation with a high impact vinyl backer provides the insulation for the section. Vertical stile members are 19 gauge hot-dipped galvanized I-beams pre-painted white to match the interior color of the door. Textured steel "C" channel, foam filled, facing boards 4" x .5625" are laminated to the face of the steel door with mechanical fasteners and an epoxy based cement. Bottom sections are reinforced with an aluminum "L" reinforcement angle riveted and bonded to the bottom of the section for supporting a replaceable UV protected grooved weather seal.

**INSULATION:** CFC-free polystyrene insulation with a rigid high impact vinyl back skin with an R-factor of 6.25.

**H-3 HARDWARE AND TRACK:** Heavy Duty commercial top and bottom fixtures with 14 gauge wide body hinges. 10 Ball white nylon rollers, galvanized torsion tube, coated spring wire, self-locking fasteners, red interior lift handles, interior lock, and .051 Vertical tracks and .060 Horizontal track. Single doors come standard with two exterior door handles and double doors with four handles.

**COLOR:** All doors are prime painted white from the factory and require post-painting. The examples shown have been painted to show some of the possibilities that further enhance the wood effect.

All doors shown are 3 section 7', 8' has 4 sections. For configurations visit our website.



Patent Pending

Steel boards are mechanically fastened and bonded to the section with epoxy based adhesive and caulked around the perimeter of each board.

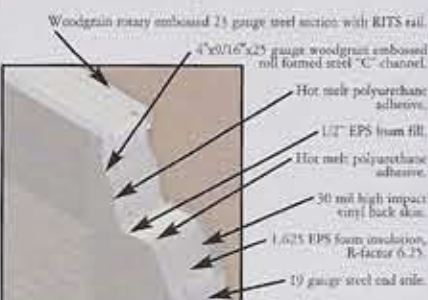

Every Original All Steel Carriage House Series door is rotary embossed with woodgrain texture.

**MODELS:** Adobe, Cimarron, Eldorado, Santa Fe, Ranchero, Pecos and Taos.

**WIDTHS & HEIGHTS:**  
Widths: 8', 9', 10', 16', and 18'  
Heights: 7' (3 section), and 8' (4 section)



WWW.FIRSTUDT.COM

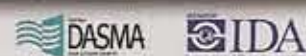

08360/FIR  
BuyLine 4566

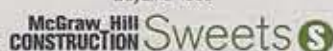

DISTRIBUTED BY:

www.firstudt.com

CHF 0804